

## Assessment Task 3

### Land Claim Instructions

1. Choose a piece of land from the three maps provided, below.
2. Complete the **Land Claim Form** using the details from the map. Every box on the form must be completed.

*Note:* You will need to find out the name of the Local Aboriginal Council for that area and the other details as required to complete the application.

3. Explain how to lodge the form. Provide details - for example, address, email, fax, etc.

## Map 1

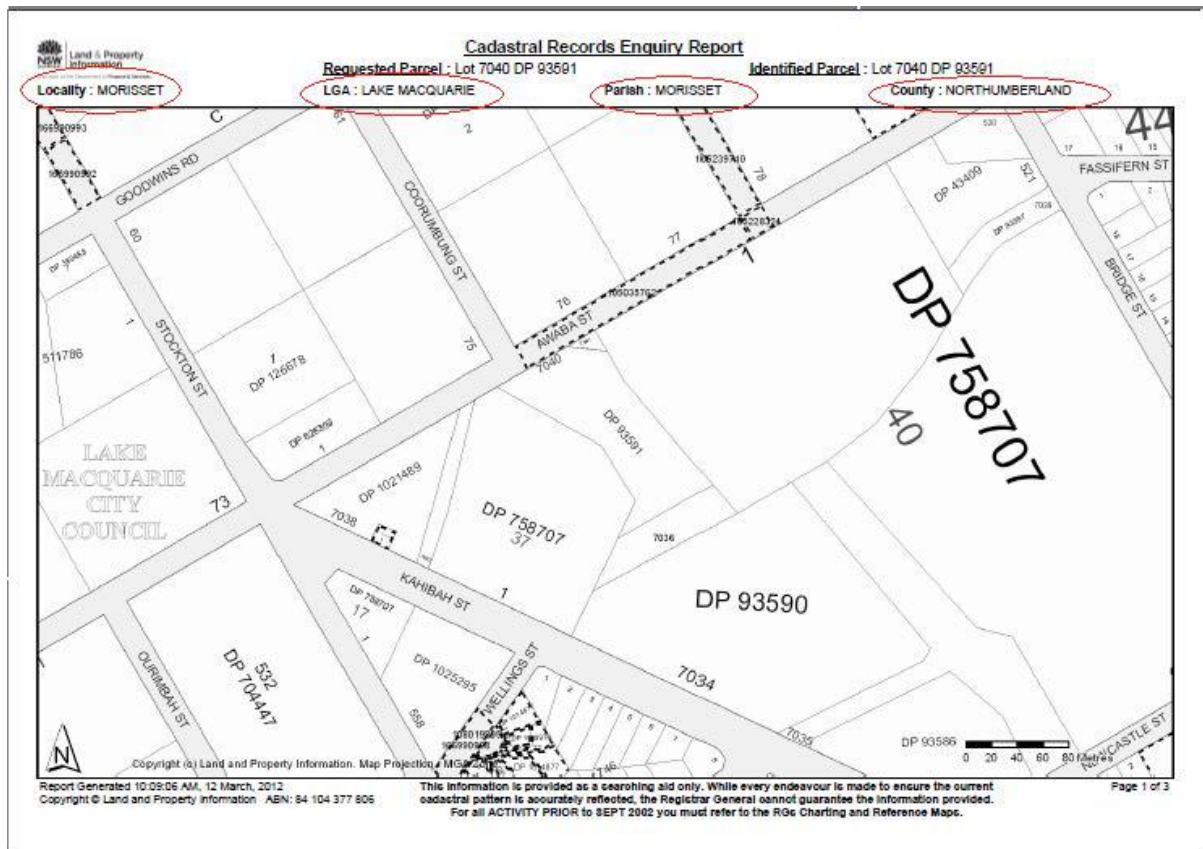

## Map 2

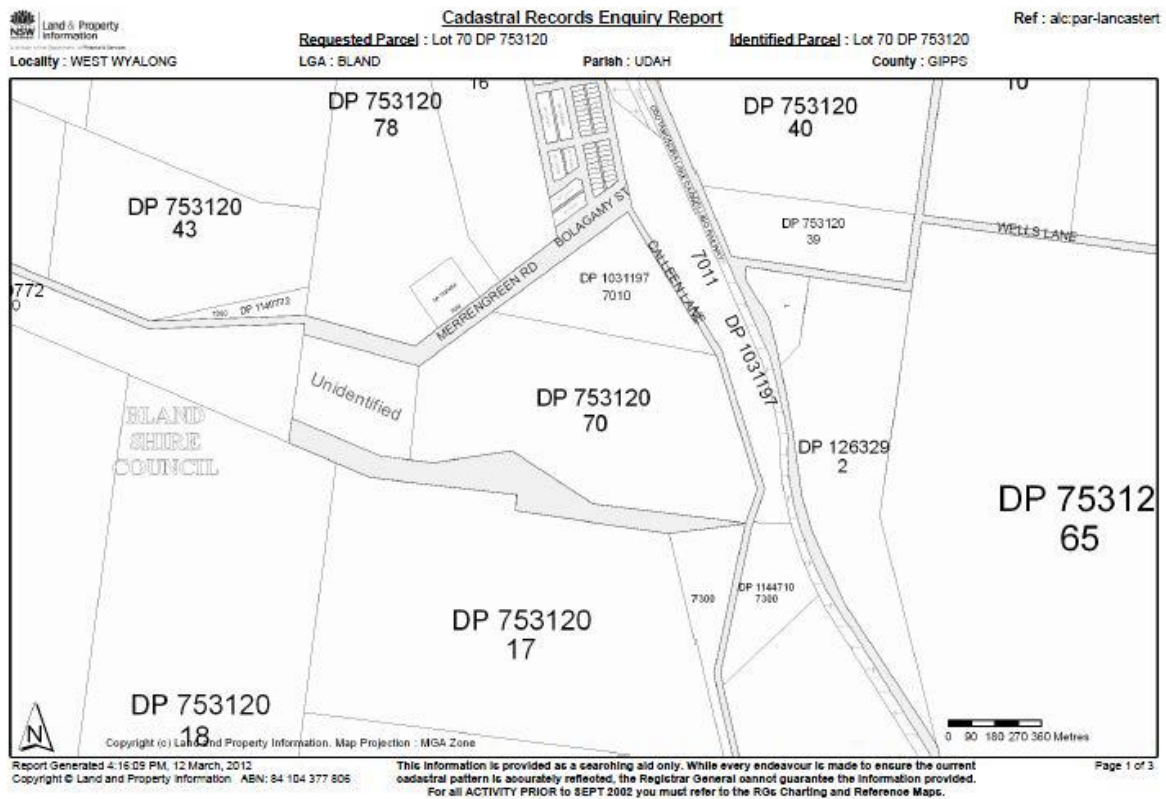

### Map 3

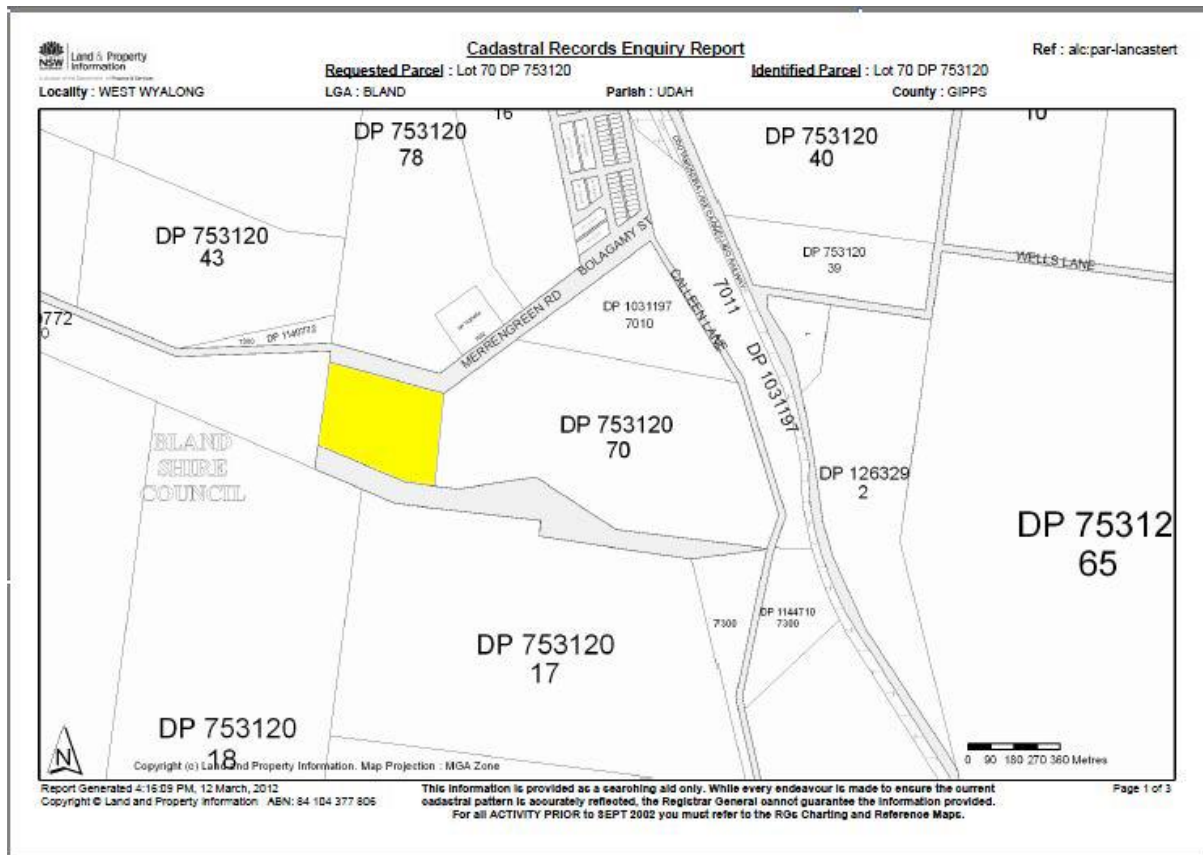

LOT/PORTION NUMBER OR RESERVE NUMBER: **UNIDENTIFIED Crown Land adjacent to Lot 70 DP 753120 as shown on the attached plan.**

NEAREST TOWN OR VILLAGE: **West Wyalong**

PARISH: **Udah**

SHIRE OR MUNICIPALITY: **Bland**

COUNTY: **Gipps**